



PUTTERILLS

est. 1992

**£1,350**

**Wansbeck Close**

Stevenage, SG1 6AA



located in a cul-de-sac, this attractive two-bedroom terraced house in Stevenage is an excellent rental opportunity. Ideal for individual couples, the property boasts a spacious floor plan that offers both comfort and convenience.

As you step into the house, you are greeted by a welcoming hallway that leads to a bright and roomy lounge/diner. The lounge/diner is bathed in natural light thanks to the glazed roof lights to

the rear aspect and twin patio doors that open to the enclosed rear garden. The garden is a private and low-maintenance outdoor space, perfect for both relaxation and entertaining. The kitchen is well-equipped, featuring modern appliances that are included in the tenancy.

Upstairs, there are two well-proportioned bedrooms. The primary bedroom is spacious enough to accommodate a double bed and additional furniture, while

the second bedroom is perfect as a single room or study. The family bathroom is well-maintained and provides a white modern three piece suite.

The house has notable features, such as gas central heating and an allocated parking space in front of the property. Living in the Great Ashby community is enriched by a range of local amenities, including a supermarket, schools, a doctor's surgery, and parks, which are all located nearby.

2



1



1

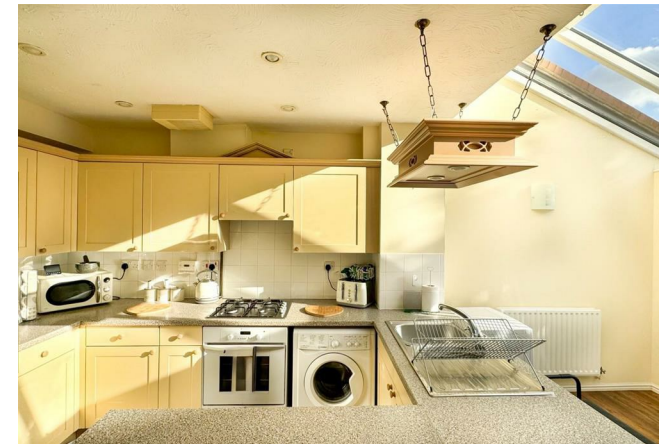













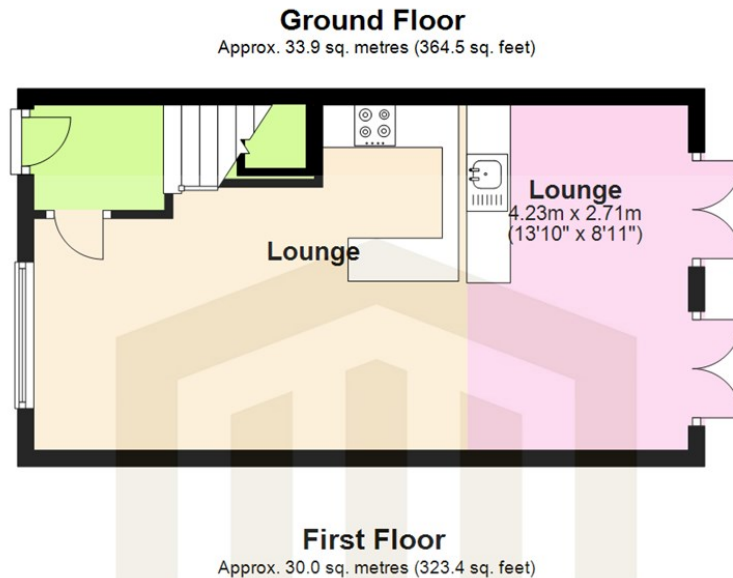

**Total area: approx. 63.9 sq. metres (687.9 sq. feet)**  
Approximate measurements not to scale for room identification purposes only  
Plan produced using PlanUp.

**LOCAL AUTHORITY**  
Stevenage

**TENURE**

**COUNCIL TAX BAND**  
C

**VIEWINGS**  
By prior appointment only

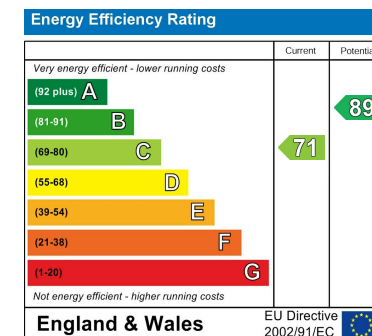

Agents Note: Whilst every care has been taken to prepare these particulars, they are for guidance purposes only. All measurements are approximate and are for general guidance purposes only and whilst every care has been taken to ensure their accuracy, they should not be relied upon and potential buyers/tenants are advised to recheck the measurements



**OFFICE ADDRESS**

Putterills Lettings  
123 London Road  
Knebworth  
SG3 6EX

**OFFICE DETAILS**

01462 419333  
lettings@putterills.co.uk  
www.putterills.co.uk